

# DESKING/PANEL 8-5X7

## 7 DAY PROGRAM TYPICAL



**3D RENDERING**

### STATION SPECIFICATIONS

- Desking System / OPS2 Panel System
- Monolithic
- 8'-5" x 7'
- 39", 53" panel heights
- Base feed power, 2 REC/station, power down spine
- Tackboard
- LED task lighting
- Paper management trays
- Frosted glass panel mounted screen
- Upmount storage cabinet w/ sliding door
- Low storage 2-drawer
- Low storage open shelf
- 37H storage tower

### FINISHES

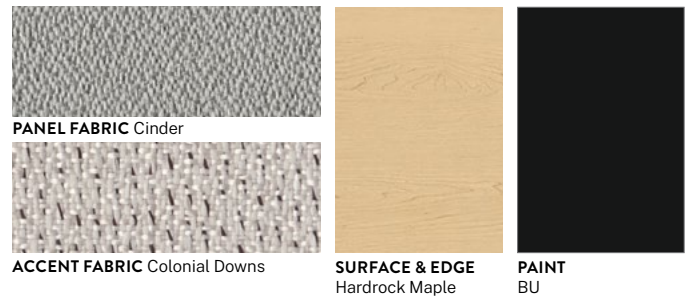

### PRICING

See next page for full BOM.

**\$19,680.00 LIST TOTAL**

Typical pricing is for reference only. Pricing must be confirmed via official Price Book or Customer Service.

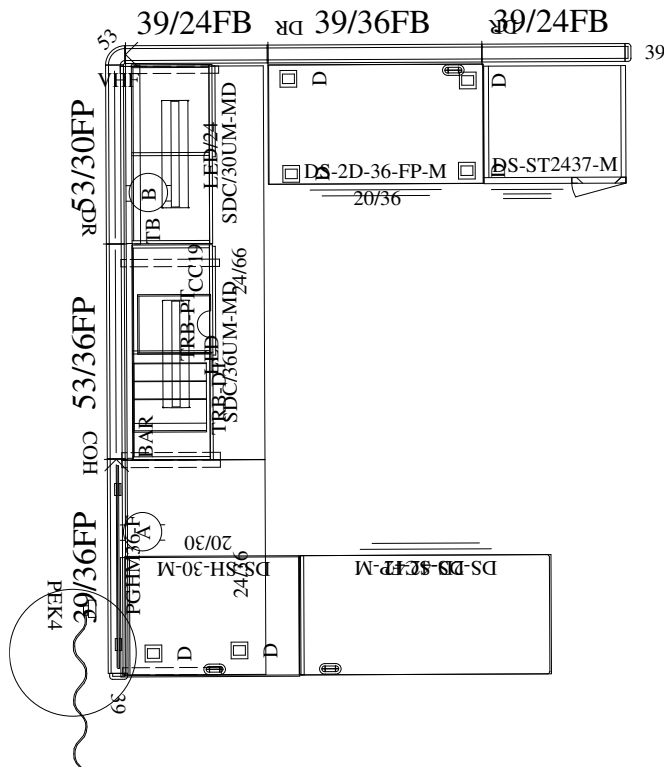

**2D PLAN LAYOUT**

# DESKING/PANEL 8-5X7

## 7 DAY PROGRAM TYPICAL



### PRICING

Part Number	Part Description	Qty	List	Ext List
DOCKLEG	3"H Docking Leg w/Adj Glide for Desking	6	\$58.00	\$348.00
F5336P	53 X 36 FABRIC PANEL - POWERED	1	\$1,039.00	\$1,039.00
F3936P	39 X 36 FABRIC PANEL - POWERED	1	\$929.00	\$929.00
F5330P	53 X 30 FABRIC PANEL - POWERED	1	\$929.00	\$929.00
SDCAB30UM-MD	30"W x 14"D Upmount Metal Storage Cabinet w/Metal Sliding Door	1	\$759.00	\$759.00
SDCAB36UM-MD	36"W x 14"D Upmount Metal Storage Cabinet w/Metal Sliding Door	1	\$819.00	\$819.00
TB30B	30" X 16" TACKBOARD- B STYLE	1	\$209.00	\$209.00
TRB36	TOOL RAIL BAR 36"	1	\$119.00	\$119.00
TRBDPT	DIAGONAL PAPER TRAY	1	\$115.00	\$115.00
TRBVPT	VERTICAL PAPER TRAY	1	\$67.00	\$67.00
F3924	39 X 24 FABRIC PANEL - W/BASE	2	\$505.00	\$1,010.00
F3936	39 X 36 FABRIC PANEL - W/BASE	1	\$619.00	\$619.00
DS-2D-36-FP-M	36"W x 20"D x 24"H Low Storage, Metal 2 Drawer, Full Pull	1	\$2,165.00	\$2,165.00
WS2436	24 X 36 WORK SURFACE	1	\$379.00	\$379.00
WS2466	24 X 66 WORK SURFACE	1	\$569.00	\$569.00
TT2036	20"D x 36"W Laminate Top for Low Storage Desking	1	\$309.00	\$309.00
TLN-LED-S-1	LED Task Light w/ Motion Sensor and Power Supply	2	\$425.00	\$850.00
DS-ST2437-M	24W X 20D X 37H METAL STORAGE TOWER	1	\$2,829.00	\$2,829.00
PGHM36.F	PANEL MOUNT FABRIC SCREEN 14H X 34W	1	\$405.00	\$405.00
EC39A2	39" END CAP	2	\$69.00	\$138.00
DS-SH-30-M	30"W X 20"D X 24"H LOW STORAGE, METAL OPEN SHELF	1	\$1,205.00	\$1,205.00
DS-2D-42-FP-M	42"W X 20"D X 24"H LOW STORAGE, METAL 2 DRAWER, FULL PULL	1	\$2,295.00	\$2,295.00
TT2030	20"D X 30"W LAMINATE TOP FOR LOW STORAGE DESKING	1	\$289.00	\$289.00
DS-SC42	42"W SEAT CUSHION FOR LOW STORAGE DESKING	1	\$289.00	\$289.00
REC/A	A CIRCUIT DUPLEX RECEPTACLES	1	\$47.00	\$47.00
REC/B	B CIRCUIT DUPLEX RECEPTACLES	1	\$47.00	\$47.00
PEK4 (L OR R)	4 CIR. BASE POWER ENTRY KIT	1	\$545.00	\$545.00
COH	CHANGE OF HEIGHT FILLER - PANEL TO PANEL	1	\$36.00	\$36.00
PTP34	34" PANEL TO PANEL CONNECTOR	3	\$30.00	\$90.00
PTP48	48" PANEL TO PANEL CONNECTOR	1	\$31.00	\$31.00
2WY53A2	53" - 2 WAY CONNECTOR	1	\$165.00	\$165.00
VHF	VARIABLE HEIGHT FILLER - PANEL TO CONNECTOR	1	\$35.00	\$35.00

**\$19,680.00 LIST TOTAL**

Typical pricing is for reference only.  
Pricing must be confirmed via official  
Price Book or Customer Service.