

PANEL 2X6 6-PACK

7 DAY PROGRAM TYPICAL



STATION SPECIFICATIONS

- OPS2 Panel System
- Monolithic
- 2' x 6' - 6-Pack
- 39" panel height
- Base feed power, 1 REC/station, power down spine
- Frosted glass panel mounted screen
- BBF-SP storage pedestal

3D RENDERING

FINISHES



PANEL FABRIC
Colonial Downs

SURFACE & EDGE
Hardrock Maple

PAINT
BU

PRICING

See next page for full BOM.

\$21,664.⁰⁰ LIST TOTAL

\$3,610.⁶⁶ PRICE PER STATION

Typical pricing is for reference only.
Pricing must be confirmed via official
Price Book or Customer Service.

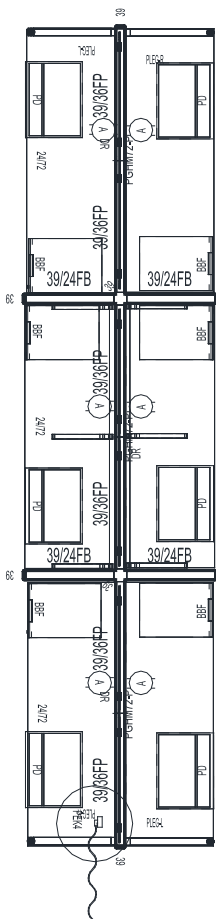

2D PLAN LAYOUT

PANEL 2X6 6-PACK

7 DAY PROGRAM TYPICAL



PRICING

Part Number	Part Description	Qty	List	Ext List
F3936P	39 X 36 FABRIC PANEL - POWERED	6	\$929.00	\$5,574.00
F3924	39 X 24 FABRIC PANEL - W/BASE	4	\$505.00	\$2,020.00
REC/A	A CIRCUIT DUPLEX RECEPTACLES	6	\$47.00	\$282.00
BBF-SP	BOX/BOX/FILE PEDESTAL, SQUARE PULL 20"D W/O TOP	6	\$755.00	\$4,530.00
PEK4 (L OR R)	4 CIR. BASE POWER ENTRY KIT	1	\$545.00	\$545.00
WS2472	24 X 72 WORK SURFACE	6	\$629.00	\$3,774.00
EC39A2	39" END CAP	6	\$69.00	\$414.00
PTP34	34" PANEL TO PANEL CONNECTOR	3	\$30.00	\$90.00
4WY39A2	39" - 4 WAY CONNECTOR	2	\$319.00	\$638.00
PDN	PENCIL DRAWER	6	\$115.00	\$690.00
PLEGL	P-Leg for 24"D Surface- Left	2	\$359.00	\$718.00
PLEGR	P-LEG FOR 24"D SURFACE- RIGHT	2	\$359.00	\$718.00
PGHM72.FG	PANEL MOUNT FROSTED TEMPERED GLASS SCREEN 14H X 70W	3	\$549.00	\$1,647.00
CRNRBR- RIGHT	CORNER BRACKET (SPEC L OR R)	1	\$12.00	\$12.00
CRNRBR- LEFT	CORNER BRACKET (SPEC L OR R)	1	\$12.00	\$12.00

\$21,664.⁰⁰ LIST TOTAL

\$3,610.⁶⁶ PRICE PER STATION

Typical pricing is for reference only.
Pricing must be confirmed via official
Price Book or Customer Service.