

U-SHAPED 2-PACK

DESKING SYSTEM TYPICAL



3D RENDERING

STATION SPECIFICATIONS

- Desking System
- 2-pack U-shaped
- 32" & 67" panel heights
- 8.75' x 8'
- Overhead sliding door unit
- Overhead open shelf unit
- Low storage 2-drawer
- Low storage sliding door cabinet
- Low storage open shelf
- Storage seat cushions
- Fabric panel mounted screens
- LED task lighting
- Tackboards
- Base feed power
- 2 REC/Station
- Power down spine

FINISHES



PRICING

See next page for full BOM.

\$34,666.⁰⁰ LIST TOTAL

\$17,333.⁰⁰ PRICE PER STATION

Typical pricing is for reference only. Pricing must be confirmed via official Price Book or Customer Service.

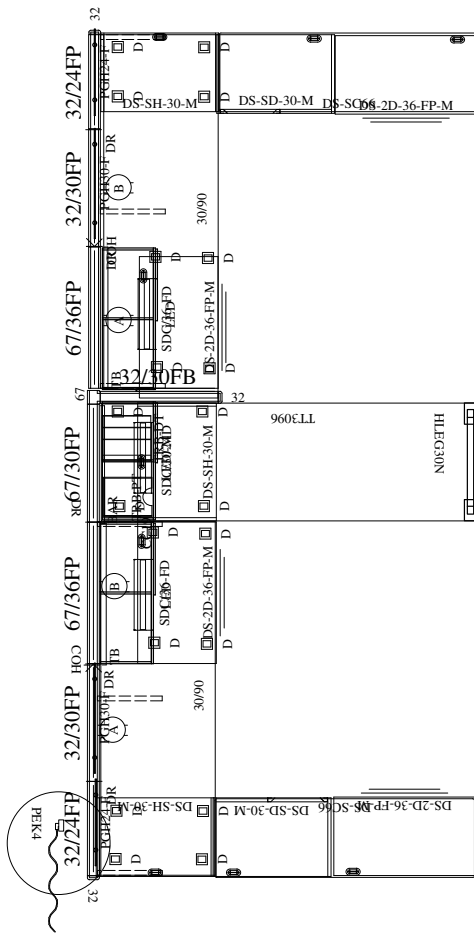

2D PLAN LAYOUT

U-SHAPED 2-PACK

DESKING SYSTEM TYPICAL

PRICING

Part Number	Part Description	Qty	List	Ext List
3WY67A2	67" - 3 WAY CONNECTOR	1	\$319.00	\$319.00
COH	CHANGE OF HEIGHT FILLER - PANEL TO PANEL	2	\$36.00	\$72.00
CRNRBR- LEFT	CORNER BRACKET (SPEC L OR R)	2	\$12.00	\$24.00
CRNRBR- RIGHT	CORNER BRACKET (SPEC L OR R)	3	\$12.00	\$36.00
DOCKLEG-E	4.5" Docking Leg w/ Adj Glide for Desking	20	\$63.00	\$1260.00
DS-2D-36-FP-M	36"W x 20"D x 24"H Low Storage, Metal 2 Drawer, Full Pull	4	\$2165.00	\$8660.00
DS-SC66	66"W Seat Cushion for Low Storage Desking	2	\$445.00	\$890.00
DS-SD-30-M	30"W x 20"D x 24"H Low Storage, Metal Sliding Door	2	\$1445.00	\$2890.00
DS-SH-30-M	30"W x 20"D x 24"H Low Storage, Metal Open Shelf	3	\$1205.00	\$3615.00
EC32A2	32" END CAP	3	\$66.00	\$198.00
F3224P	32 X 24 FABRIC PANEL - POWERED	2	\$799.00	\$1598.00
F3230	32 X 30 FABRIC PANEL - W/BASE	1	\$529.00	\$529.00
F3230P	32 X 30 FABRIC PANEL - POWERED	2	\$855.00	\$1710.00
F6730P	67 X 30 FABRIC PANEL - POWERED	1	\$1029.00	\$1029.00
F6736P	67 X 36 FABRIC PANEL - POWERED	2	\$1135.00	\$2270.00
HLEG30S	Square H-Leg for 30"D Surface	1	\$435.00	\$435.00
PEK4 (L OR R)	4 CIR. BASE POWER ENTRY KIT	1	\$545.00	\$545.00
PGHM24.F	Panel Mount Fabric Screen 14H x 22W	2	\$349.00	\$698.00
PGHM30.F	Panel Mount Fabric Screen 14H x 28W	2	\$379.00	\$758.00
PTP27	27 PANEL TO PANEL CONNECTOR	4	\$29.00	\$116.00
PTP62	62" PANEL TO PANEL CONNECTOR	1	\$31.00	\$31.00
REC/A	A CIRCUIT DUPLEX RECEPTACLES	2	\$47.00	\$94.00
REC/B	B CIRCUIT DUPLEX RECEPTACLES	2	\$47.00	\$94.00
SDCAB30-MD	30"W x 14"D Metal Storage Cabinet w/Metal Sliding Door	1	\$569.00	\$569.00
SDCAB36-FD	36"W x 14"D Metal Storage Cabinet w/Fabric Sliding Door	2	\$799.00	\$1598.00
SQLEG	2"W x 27.5"H Square Desk Leg	1	\$255.00	\$255.00
TB36B	36" X 16" TACKBOARD- B STYLE	2	\$225.00	\$450.00
TLN-LED-24-S	Conn. Cord adjoining 36" & 42" shelves	1	\$19.00	\$19.00
TLN-LED-S-1	LED Task Light w/ Motion Sensor and Power Supply	2	\$425.00	\$850.00
TRB30	TOOL RAIL BAR 30"	1	\$115.00	\$115.00
TRBDPT	DIAGONAL PAPER TRAY	1	\$115.00	\$115.00
TRBVPT	VERTICAL PAPER TRAY	1	\$67.00	\$67.00
TT3096	30 X 96 Training Table Top (No Hardware Or Bases)	1	\$899.00	\$899.00
WS3090	30 X 90 WORK SURFACE	2	\$929.00	\$1858.00

\$34,666.00 LIST TOTAL

\$17,333.00 PRICE PER STATION

Typical pricing is for reference only.
Pricing must be confirmed via official
Price Book or Customer Service.