

BENCHING 2-6X5 6-PACK

FREESTANDING TYPICAL



STATION SPECIFICATIONS

- Freestanding / Benching
- 2'-6" x 5' - 6-Pack
- Pencil drawer
- Fabric work surface mounted screen
- BBF-FP storage pedestal

3D RENDERING

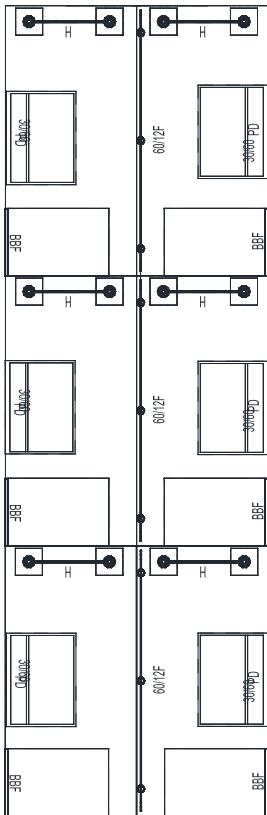

2D PLAN LAYOUT

FINISHES



FABRIC
Strata Cement



SURFACE
Hardrock Maple



PAINT & EDGE
MT

PRICING

See next page for full BOM.

\$13,029.⁰⁰ LIST TOTAL

\$2,171.⁵⁰ PRICE PER STATION

Typical pricing is for reference only.
Pricing must be confirmed via official
Price Book or Customer Service.

BENCHING 2-6X5 6-PACK

FREESTANDING TYPICAL



PRICING

Part Number	Part Description	Qty	List	Ext List
TT3060	30 X 60 Training Table Top (No Hardware Or Bases)	6	\$555.00	\$3,330.00
PGHM60.F	Panel Mount Fabric Screen 14H x 58W	3	\$475.00	\$1,425.00
HLEG30	H-Leg For 30" Worksurface	6	\$435.00	\$2,610.00
BBF-FP	BOX/BOX/FILE PEDESTAL FULL PULL 23"D W/O TOP	6	\$829.00	\$4,974.00
PDN	PENCIL DRAWER	6	\$115.00	\$690.00

\$13,029.00 LIST TOTAL

\$2,171.50 PRICE PER STATION

Typical pricing is for reference only.
Pricing must be confirmed via official
Price Book or Customer Service.