

RECEPTION STATION

OPS2 PANEL SYSTEM TYPICAL



3D RENDERING

STATION SPECIFICATIONS

- OPS2 Panel System
- Monolithic
- 47", 67" panel heights
- 9' x 11'
- Flipper door unit & shelf
- BBF-SP storage pedestal
- 2-drawer lateral file
- LED task lighting
- Tackboards
- Paper management trays
- Base feed power
- 2 REC/Station
- Power down spine

FINISHES



PANEL FABRIC Rattan Sky

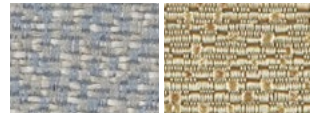

ACCENT FABRIC Midway Chambray
ACCENT FABRIC Century Oro



PAINT & EDGE MT



SURFACE Hardrock Maple

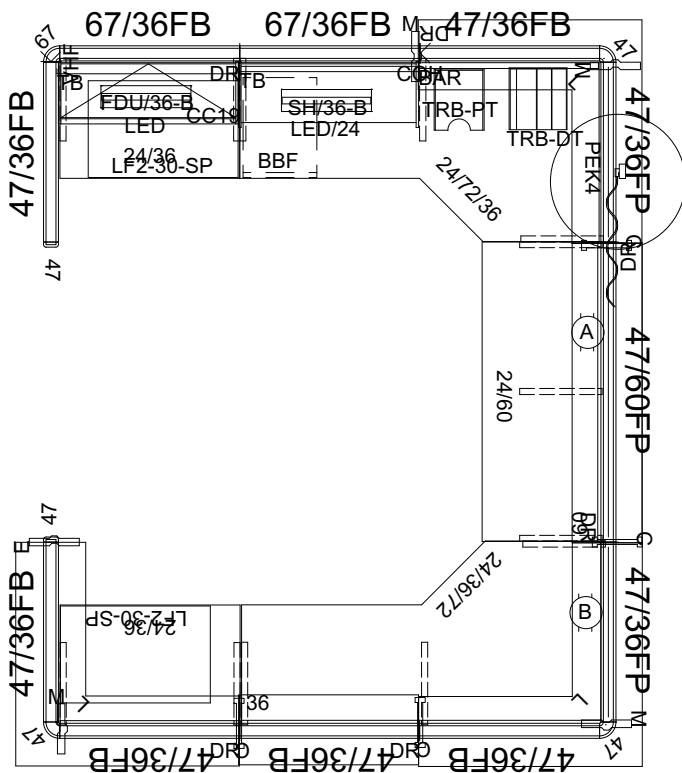

2D PLAN LAYOUT

PRICING

See next page for full BOM.

\$22,994.⁰⁰ PRICE PER STATION

Typical pricing is for reference only.
Pricing must be confirmed via official
Price Book or Customer Service.

RECEPTION STATION

OPS2 PANEL SYSTEM TYPICAL



PRICING

Part Number	Part Description	Qty	List	Ext List
2WY47A2	47" - 2 WAY CONNECTOR	3	\$165.00	\$495.00
2WY67A2	67" - 2 WAY CONNECTOR	1	\$185.00	\$185.00
BBF-SP	BOX/BOX/FILE PEDESTAL, SQUARE PULL 20"D W/O TOP	1	\$755.00	\$755.00
CB	CENTER BRACKET	4	\$47.00	\$188.00
CC36	36" COUNTER CAP	1	\$225.00	\$225.00
CC60	60" COUNTER CAP	1	\$309.00	\$309.00
CCC4444SQ	44 7/8 X 44 7/8 SQUARE CORNER COUNTER CAP- 36W PANELS	3	\$569.00	\$1707.00
COH	CHANGE OF HEIGHT FILLER - PANEL TO PANEL	1	\$36.00	\$36.00
EB	END BRACKET	1	\$46.00	\$46.00
EC47A2	47" END CAP	2	\$73.00	\$146.00
ECWS362472L	36 X 24 X 72 CORNER WORK SURFACE - LEFT EXTENSION	1	\$999.00	\$999.00
ECWS362472R	36 X 24 X 72 CORNER WORK SURFACE - RIGHT EXTENSION	1	\$999.00	\$999.00
F4736	47 X 36 FABRIC PANEL - W/BASE	6	\$679.00	\$4074.00
F4736P	47 X 36 FABRIC PANEL - POWERED	2	\$999.00	\$1998.00
F4760P	47 X 60 FABRIC PANEL - POWERED	1	\$1269.00	\$1269.00
F6736	67 X 36 FABRIC PANEL - W/BASE	2	\$815.00	\$1630.00
FDU3612B	36 X 12 FLIPPER DOOR UNIT- B STYLE	1	\$579.00	\$579.00
LF2-30-SP	30"W Lateral File, Square Pull, 2 Drawer	2	\$1459.00	\$2918.00
MEB	MID END BRACKET	3	\$46.00	\$138.00
MEBCOHV2	MID END BRACKET WITH COH	1	\$46.00	\$46.00
PEK4 (L OR R)	4 CIR. BASE POWER ENTRY KIT	1	\$545.00	\$545.00
PTP42	42" PANEL TO PANEL CONNECTOR	5	\$30.00	\$150.00
PTP62	62" PANEL TO PANEL CONNECTOR	1	\$31.00	\$31.00
REC/A	A CIRCUIT DUPLEX RECEPTACLES	1	\$47.00	\$47.00
REC/B	B CIRCUIT DUPLEX RECEPTACLES	1	\$47.00	\$47.00
SH3612B	36 X 12 SHELF - B STYLE	1	\$225.00	\$225.00
SQLEG	2"W x 27.5"H Square Desk Leg	1	\$255.00	\$255.00
TB36B	36" X 16" TACKBOARD- B STYLE	2	\$225.00	\$450.00
TLN-LED-24-S	Conn. Cord adjoining 36" & 42" shelves	1	\$19.00	\$19.00
TLN-LED-S-1	LED Task Light w/ Motion Sensor and Power Supply	2	\$425.00	\$850.00
TRB36	TOOL RAIL BAR 36"	1	\$119.00	\$119.00
TRBDPT	DIAGONAL PAPER TRAY	1	\$115.00	\$115.00
TRBVPT	VERTICAL PAPER TRAY	1	\$67.00	\$67.00
VHF	VARIABLE HEIGHT FILLER - PANEL TO CONNECTOR	1	\$35.00	\$35.00
WS2436	24 X 36 WORK SURFACE	2	\$379.00	\$758.00
WS2460	24 X 60 WORK SURFACE	1	\$539.00	\$539.00

\$22,994.00 PRICE PER STATION

Typical pricing is for reference only.
Pricing must be confirmed via official
Price Book or Customer Service.