

# 2-PACK PANEL/DESKING

## RAZOR SYSTEM TYPICAL



**3D RENDERING**

### STATION SPECIFICATIONS

- Razor System w/ Panel & Desking
- 2-pack monolithic & partial glazed stackers
- 6' x 7'
- 32", 67" panel heights
- Low storage 2-drawer lateral file
- Low storage open shelf
- Overhead half height shelf
- Storage seat cushion
- Keyboard set
- LED task lighting
- Base feed power
- 2 REC/Station
- Power down spine

### FINISHES

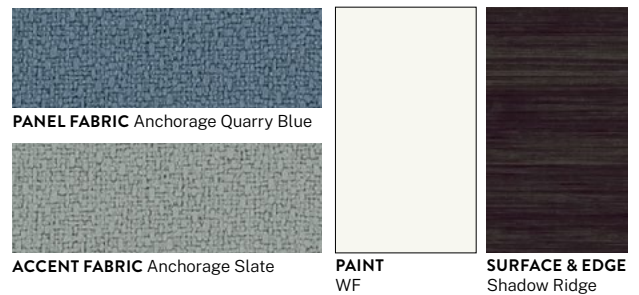

### PRICING

See next page for full BOM.

**\$24,951.<sup>00</sup> LIST TOTAL**

**\$12,475.<sup>50</sup> PRICE PER STATION**

Typical pricing is for reference only.  
Pricing must be confirmed via official Price Book or Customer Service.

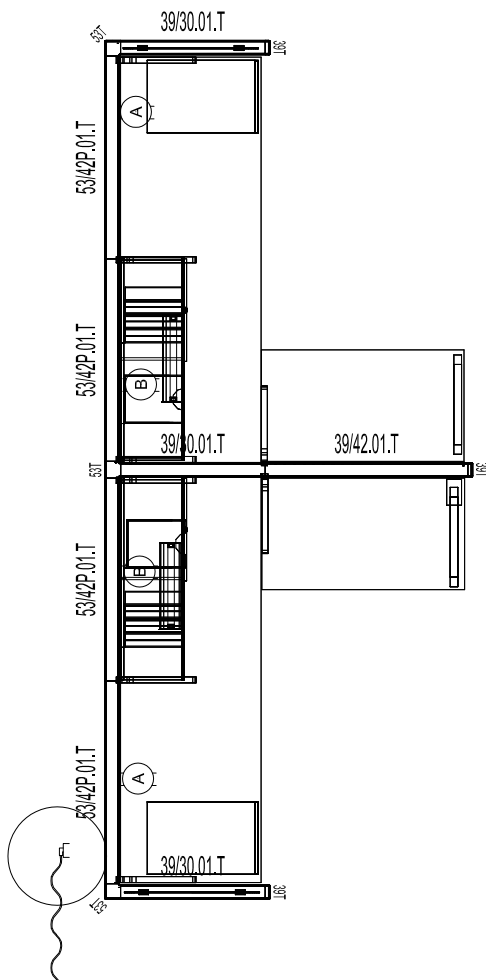

**2D PLAN LAYOUT**

# 2-PACK PANEL/DESKING

## RAZOR SYSTEM TYPICAL



### PRICING

Part Number	Part Description	Qty	List	Ext List
2WY53A2.T	53" 2 WAY CONNECTOR - THIN BASE	2	\$165.00	\$330.00
3WY53A2.T	53" 3 WAY CONNECTOR - THIN BASE	1	\$289.00	\$289.00
COH	CHANGE OF HEIGHT FILLER - PANEL TO PANEL	3	\$36.00	\$108.00
CRNRBR- LEFT	CORNER BRACKET (SPEC L OR R)	1	\$12.00	\$12.00
CRNRBR- RIGHT	CORNER BRACKET (SPEC L OR R)	1	\$12.00	\$12.00
DOCKLEG	3"H Docking Leg w/Adj Glide for Desking	8	\$58.00	\$464.00
DS-2D-42-FP-M	42"W x 20"D x 24"H Low Storage, Metal 2 Drawer, Full Pull	2	\$2,295.00	\$4,590.00
DS-SC42	42"W Seat Cushion for Low Storage Desking	2	\$289.00	\$578.00
DS-SH-42-M	42"W x 20"D x 24"H Low Storage, Metal Open Shelf	2	\$1,445.00	\$2,890.00
EC39A2.T	39" END CAP W/ THIN BASE	3	\$69.00	\$207.00
F3936.T	39 X 36 FABRIC PANEL - THIN BASE	3	\$619.00	\$1,857.00
F5342PT	53 X 42 FABRIC PANEL - POWERED THIN BASE	2	\$1,099.00	\$2,198.00
PEK4 (L OR R)	4 CIR. BASE POWER ENTRY KIT	1	\$545.00	\$545.00
PGSF5336-3914.T	53 (39-14) x 36 Fabric Stack Glass Panel - Thin Base	3	\$1,169.00	\$3,507.00
PGSF5342P-3914.T	53 (39-14) x 42 Fabric Stack Glass Panel - Powered - Thin Base	2	\$1,659.00	\$3,318.00
PLEGL	P-Leg for 24"D Surface- Left	1	\$359.00	\$359.00
PLEGR	P-Leg for 24"D Surface- Right	1	\$359.00	\$359.00
PTP34	34" PANEL TO PANEL CONNECTOR	3	\$30.00	\$90.00
PTP48	48" PANEL TO PANEL CONNECTOR	2	\$31.00	\$62.00
REC/A	A CIRCUIT DUPLEX RECEPTACLES	2	\$47.00	\$94.00
REC/B	B CIRCUIT DUPLEX RECEPTACLES	2	\$47.00	\$94.00
SHH4212B	42 X 12 HALF HEIGHT SHELF - B STYLE	2	\$185.00	\$370.00
TLN-LED-S-1	LED Task Light w/ Motion Sensor and Power Supply	2	\$425.00	\$850.00
TT2042	20"D x 42"W Laminate Top for Low Storage Desking	2	\$335.00	\$670.00
TT2472	24 X 72 Training Table Top (No Hardware Or Bases)	2	\$549.00	\$1,098.00

**\$24,951.00 LIST TOTAL**

**\$12,475.50 PRICE PER STATION**

Typical pricing is for reference only.  
Pricing must be confirmed via official  
Price Book or Customer Service.