

10X12 107H

MODULAR WALL TYPICAL



3D RENDERING

STATION SPECIFICATIONS

- Modular Wall office
- 10' x 12'
- 107" Panel Height
- 85H standard door
- Pencil drawer
- LED task lighting
- BBF-FP storage pedestal
- 3-drawer storage lateral file
- Overhead flipper door storage unit

FINISHES



ACCENT FABRIC
Anchorage Fossil

SURFACE & EDGE
Shadow Ridge

PAINT
HF

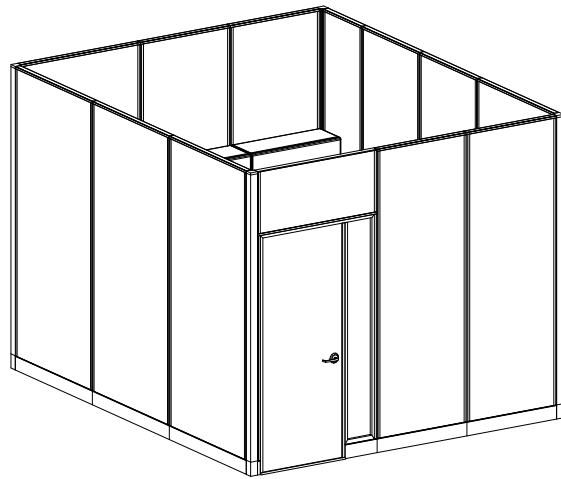

3D PLAN LAYOUT

PRICING

See next page for full BOM.

\$31,973.00 LIST TOTAL

Typical pricing is for reference only.
Pricing must be confirmed via official
Price Book or Customer Service.

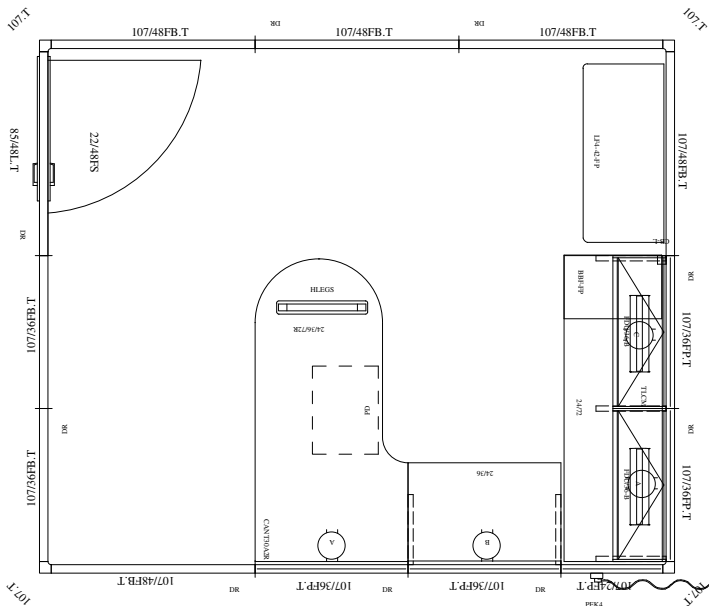

2D PLAN LAYOUT

10X12 107H

MODULAR WALL TYPICAL



PRICING

Part Number	Part Description	Qty	List	Ext List
2WY107A2.T	107" 2 WAY CONNECTOR - THIN BASE	4	\$235.00	\$940.00
BBF-FP	BOX/BOX/FILE PEDESTAL FULL PULL 23"D W/O TOP	1	\$829.00	\$829.00
CANT30A2R	24" Cant Paint Up-Charge, Right (for 30" Surfaces)	1	\$14.00	\$14.00
CRNRBR- LEFT	CORNER BRACKET (SPEC L OR R)	1	\$12.00	\$12.00
DOORPNL85L.T	85" DOOR PANEL 48" WIDE W/ LITE A02 SERIES (L SWING) THIN BASE	1	\$3205.00	\$3205.00
ECCPEN243672R	24 X 36 X 72 -Rt. Ext. Curved (No Leg)	1	\$939.00	\$939.00
F10724P.T	107 X 24 FABRIC PANEL - POWERED THIN BASE	1	\$1369.00	\$1369.00
F10736.T	107 X 36 FABRIC PANEL - THIN BASE	2	\$1325.00	\$2650.00
F10736P.T	107 X 36 FABRIC PANEL - POWERED THIN BASE	4	\$1629.00	\$6516.00
F10748.T	107 X 48 FABRIC PANEL - THIN BASE	5	\$1509.00	\$7545.00
FDU3612B	36 X 12 FLIPPER DOOR UNIT- B STYLE	2	\$579.00	\$1158.00
HLEGS	Square H-Leg for 24"D Surface	1	\$359.00	\$359.00
LF3-42-FP	42"W Lateral File, Full Pull, 3 Drawer	1	\$2595.00	\$2595.00
PDN	PENCIL DRAWER	1	\$115.00	\$115.00
PEK4 (L OR R)	4 CIR. BASE POWER ENTRY KIT	1	\$545.00	\$545.00
PTP102	102 PANEL TO PANEL CONNECTOR	9	\$54.00	\$486.00
REC/A.T	A Circuit Duplex Receptacle - Thin Base	2	\$47.00	\$94.00
REC/B.T	B Circuit Duplex Receptacle - Thin Base	1	\$47.00	\$47.00
REC/C.T	C Circuit Duplex Receptacle - Thin Base	1	\$47.00	\$47.00
SF2248	22 X 48 FABRIC STACK PANEL	1	\$609.00	\$609.00
TLCM	TASK LIGHT CORD MANAGER (BU ONLY) 4'	1	\$22.00	\$22.00
TLN-LED-24-S	CONN. CORD ADJOINING 36" & 42" SHELVES	1	\$19.00	\$19.00
TLN-LED-S-1	LED TASK LIGHT W/ MOTION SENSOR AND POWER SUPPLY	2	\$425.00	\$850.00
WS2436	24 X 36 WORK SURFACE	1	\$379.00	\$379.00
WS2472	24 X 72 WORK SURFACE	1	\$629.00	\$629.00

\$31,973.00 LIST TOTAL

Typical pricing is for reference only.
Pricing must be confirmed via official
Price Book or Customer Service.